

**DISPATCH**

**SECRET**

TO Chief, KURIOT Attn: Photographic Branch	XX	MARKED FOR INDEXING NO INDEXING REQUIRED ONLY QUALIFIED DESK CAN JUDGE INDEXING
FROM Chief, WH Division Chief of Station, Mexico City		
SUBJECT Operational Monthly Report -- 1-31 December 1963		MICROFILM

ACTION REQUIRED: REFERENCES

Action: None. For your information.

Presented below is a reporting of the operational and support activities of Gregory D. PARMUTH for the above mentioned period.

1. General Summary of Activities.

Activity for the month of December consisted of the following: Installation of the SEQUENCE camera at the LIERODE basehouse; Assistance was given to C/MKCHARITY on an audio operation against an LCHARVEST target; A locked door containing audio equipment was opened by PARMUTH at an LP monitoring the LCHARVEST apartment; Station production totaled 2,325 for the month; One agent was trained in SW; and Photographic basehouses covering Soviet and Satellite Embassies produced below average production because of the Christmas season.

2. TDY

On 16 December 1963 Peter T. SWINEHART, POB, arrived at Mexico City to install a SEQUENCE camera at the LIERODE basehouse. See para 5.g. of this report for details.

On 17 December 1963 an SWB representative arrived at Mexico City

(continued)

- Encl:
1. Training Report (KASNICKA)
  2. Sequence Camera reports (3)
  3. SWB Report

ES COPY

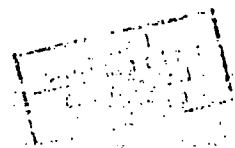

- Distribution:
- 1/2 - KURIOT, w/encls
  - 1 - WH, w/o encls

50-6-18

CROSS REFERENCE TO <i>no title</i>	DISPATCH SYMBOL AND NUMBER HMMA-22726	DATE 16 January 1964
	CLASSIFICATION SECRET	HQS FILE NUMBER 50-6-18

0004098

17707

for the purpose of training PARMUTH in the use of SW system 99.

3. Training.

See training report forwarded as Enclosure 1 on Lewis F. KASNICKA.

4. Operations.

None.

5. Station Support.

a. On the morning of 1 December 1963, PARMUTH assisted RESCIGNO in installing audio microphones under the flooring of an LCHARVEST occupied apartment. (See HMMA-22608, 11 Dec 63, para 5.d.) Lines leading from the audio installation to the LP were strung and secured below the flooring which had ample semi-crawling space between the target area and the LP apartment. RESCIGNO and PARMUTH entered this crawling space by removing a small section of flooring located inside the LP apartment. There is also a trap door leading into the crawl space at the front entrance hall of the building although the curious would be discouraged to enter this area because of stagnant water six to ten inches deep on the floors at all times, cob webs, bugs, etc., etc... Three audio microphones were installed on this operation.

b. During the period 2-14 December 1963, PARMUTH again handled LFIRES 4/5 while Marvin A. CABOT was on annual leave.

c. On 6 December 1963 PARMUTH forwarded to KURIOT/WAVE Headquarters two orders of envelopes (six month supply per each request) and one request for stamps. The envelopes were handcarried by Timothy A. GAPRIOTT to WAVE Headquarters, avoiding a week's delay if the envelopes were sent through the pouch from Mexico City. The stamps were handcarried by another TDYer to the States for mailing to Washington.

d. On 6 December 1963 PARMUTH was requested to re-enter the LP covering the LCHARVEST apartment as reported in para 5.a. of this report. The purpose of this visit was to unlock a closed door which stored the LP equipment which monitors LCHARVEST activities in that apartment. Although the basehouse keeper had a key which worked well for several days previously, the lock would not open for the agent on the afternoon of 6 December. PARMUTH entered the apartment at 0130 hours on 7 December and unlocked the door. It was found that the throw bolt located inside the lock was broken. For security purposes, two other locks were removed from other doors located in the same room to check if these locks were in the same bad condition. In each case, when the key was inserted into the lock and turned excessively, the throw bolt snapped. A new lock of the same type manufacture was installed on the closet door by the basehouse keeper on 7 December 1963.

e. On the night of 7 December 1963, PARMUTH was requested by the COS to install an extension phone at the COS residence. After a short training period given by RESCIGNO at the MKCHARITY base, PARMUTH was able to service this request satisfactorily. This extension was one which replaced one removed (for study) by KUSODA officials who inspected Mexico.

f. On 10 December 1963 PARMUTH photographed 423 frames, using the Recordak to fulfill a monthly Staff D requirement for the Chief of Station.

g. On the morning of 17 December 1963, SWINEHART, LIFEUD/2 and PARMUTH met at the LIERODE basehouse to install the 35mm SEQUENC camera and the VLS-2 trigger device. SWINEHART instructed both L-22 and PARMUTH very thoroughly on the installation and maintenance of the SEQUENC

FORM  
10 57 53a  
(43)

USE PREVIOUS EDITION  
REPLACES FORMS  
51 23 51 28A AND 51 27  
WHICH ARE OBSOLETE

CLASSIFICATION

SECRET

0004098

CONTINUED

PAGE #

2

PAGE 8 of 22  
COPY NO.

camera. The complete system was then dismantled by SWINEHART so that L-22 could re-install the system from the beginning. This was done by L-22 and met with SWINEHART's satisfaction. Although the Consulate door was closed to the public for a period of six days for unknown reasons as of the night of 17 December 1963, tests were made using the SEQUENCE camera photographing people walking by the Consulate door. The camera worked well and produced good printable negatives. On the morning of 18 December 1963, L-22 contacted PARMUTH and explained that the Consulate door was now open to the public and receiving visitors as of 1010 that day. PARMUTH and SWINEHART joined L-22 shortly later at the LIERODE basehouse and found that the camera system was working well and photographing people entering and leaving this target area. SWINEHART then processed this film at the Station lab and made sample prints of the day's take to be presented to the COS and C/PBRUMEN for their approval. Both were very pleased with the photographic results using this type of camera equipment, at the LIERODE basehouse. As of this reporting, the SEQUENCE camera is using approximately 100 feet of Plus X film between 0900 and 1400 hours (office hours for the Consulate). L-23 uses the present dark room area to photograph traffic entering and leaving the front gate of the Embassy and is on duty from 0800 to 1800 hours daily, six days a week. In order for L-22 to process the film from both of these cameras and make prints daily, it will be necessary to install another darkroom at the basehouse. L-22 will need a Morse Tank for processing film, a drying rack, and a small PAKO dryer for finishing prints in order to satisfy PBRUMEN requirements at the Station. Forwarded as enclosure 2 is the installation, ~~and~~ statistical and training report concerning this operation.

h. On the night of 17 December 1963, PARMUTH and SWINEHART went to the Mexico City Airport to meet a visiting SWB TDYer and assisted him through customs. Before the plane arrived, PARMUTH and SWINEHART took the opportunity to inspect the passport camera located in the Immigration Section of the Airport.

i. On the evening of 31 December 1963, PARMUTH was requested by Michael C. CHODEN, C/PBRUMEN Operations Officer, to make an emergency meeting with LIFEUD/22. The purpose of this meeting was to pick up photographs and logs for 30 and 31 December in connection with a priority PBRUMEN operation.

#### 6. Station Support (SW Activity).

a. On 6 December 1963, a visiting TDYer from Tegucigalpa requested PARMUTH to train SWLUCK/1 in secret writing. Training was carried out on 7 December 1963 at a local hotel in the city. SW systems 37 and 58 were used in this operation as per KURIOT instruction in DIR-87130. Forwarded as enclosure 3 is the SW report which is to be sent to SWB.

b. On 20 December 1963, PARMUTH was trained in the use of SW system 99 by a visiting KURIOT technician.

#### 7. Miscellaneous Statistics.

- a. Number of operational targets surveys completed during month: 0.
- b. Number of TDY trips completed during the month: 0.
- c. Photographic equipment issued for operational use: SEQUENCE camera.
- d. Photographic equipment repaired: 0.
- e. Number of people trained in photographic techniques/equipment: 2.

0004100

FORM 53a 101	USE PREVIOUS EDITION REPLACES FORMS SI-28, SI-28A AND SI-27 WHICH ARE OBSOLETE	CLASSIFICATION SECRET	<input checked="" type="checkbox"/> CONTINUED	PAGE NO 3.
-----------------	---	--------------------------	---	---------------